

ITEM	DESCRIPTION
CAB 196	DOOR LATCH
CAB383FGPKIT	FOOT VALVE (PRESSURE)
CAB383FGPKIT	FOOT VALVE (SUCTION)
HC 5327 1	SPIGOT - 3" FLANGED (90 DEG.)
HC 5527 1	SPIGOT - 3" FLANGED (90 DEG.)
HOSE 13	HOSE-3" HEAVY DUTY SUCTION
HOSE 20	HOSE-3" FLEXIBLE RUBBER STD.
JC 3	HOSE CLIP (70 - 89)

ITEM	DESCRIPTION
HC 5068	CABINET ARM HOLES - PLASTIC
IND 10123	SLEEVE/GLOVE ASSEMBLY
CAB FM7	CLIP FOR SLEEVE
IND 10019	GLOVE REINFORCING RING
IND 10020	RUBBER GLOVES (PAIR)
IND 10124	SLEEVE
JC 5	HOSE CLIP 114-140

ITEM	DESCRIPTION
HC 4564 1	ABRASIVE FEED PIPE
HC 4564 2	ABRASIVE CHUTE - 20 x 20
IND 1290COMP & IND 1500COMP	FOR PRESSURE & SUCTION REGRADER CABINETS ONLY
CAB 154	ABRASIVE CHUTE 800P/1200P

ITEM	DESCRIPTION
IND 800COMP & IND 1000COMP	FOR PRESSURE & SUCTION REGRADER CABINETS ONLY
P 208	2" - 1" REDUCING NIPPLE

ITEM	DESCRIPTION
12417A	VALVE MEDIA METERING ASS'Y

ITEM	DESCRIPTION
HC 6623	IND 800COMP - ALL
HC 6624	IND 1000COMP - ALL
HC 6625	IND 1250COMP SUCTON REGRADER
HC 6626	IND 1250COMP SUCTON
HC 6627	IND 1500COMP PRESSURE & SUCTION REGRADER
HC 6578	IND 1500COMP SUCTON

ITEM	DESCRIPTION
HC 6623 4	IND 800COMP
HC 6624 4	IND 1000COMP
HC 6625 4	IND 1250COMP
HC 5288	IND 1500COMP

ITEM	DESCRIPTION
HC 6623 3	IND 800COMP
HC 6624 3	IND 1000COMP
HC 6625 3	IND 1250COMP WITH HC 6626 FABRICATION
HC 6626 3	HC 6626 FABRICATION
HC 6627 4	IND 1500COMP WITH HC 6627 FABRICATION
HC 6578 4	IND 1500COMP WITH HC 6578 FABRICATION

ITEM	DESCRIPTION
HC 6623 7	IND 800COMP
HC 6624 7	IND 1000COMP
HC 6625 7	IND 1250COMP
HC 6627 6	IND 1500COMP

ITEM	DESCRIPTION
HC 5132	LIGHT MODULE FABRICATION
CAB 16	LIGHT FITTING
CAB 73A	ENCLOSURE
IND 10679	PUSH-BUTTON ASSY - DOUBLE
IND 206	CONTACTOR - N.C.
IND 206A	CONTACTOR - N.O.

ITEM	DESCRIPTION
HC 5132 2	WINDOW FRAME
CAB LD29	VIEWING WINDOW
CAB LD 34	ANTI-ETCH SCREEN (5 PER SET)

FOR MINOR PARTS & FITTINGS,  
SEE RELEVANT G.A. DRAWING,  
FOR INDIVIDUAL CABINET SYSTEM.

ISSUE No	MOD. No	DATE
1	ORIGINAL	27.10.99
2	3827	31.07.2002

THIS DOCUMENT IS THE PRIVATE & CONFIDENTIAL PROPERTY OF HODGE CLEMO LIMITED & MUST NOT BE REPRODUCED OR DISCLOSED TO ANY THIRD PARTY WITHOUT PRIOR WRITTEN CONSENT OF THE AFOREMENTIONED COMPANY.

**Enviroclean**

HODGE CLEMO LIMITED,  
ORGRFAVE DRIVE,  
SHEFFIELD,  
S13 9NR,  
TEL. 0114 2540600  
FAX. 0114 2540250

MAJOR PARTS BREAKDOWN  
DRAWING FOR COMP CABINETS  
ISOMETRIC  
PROJECTION  
DRAWING No HC-6693

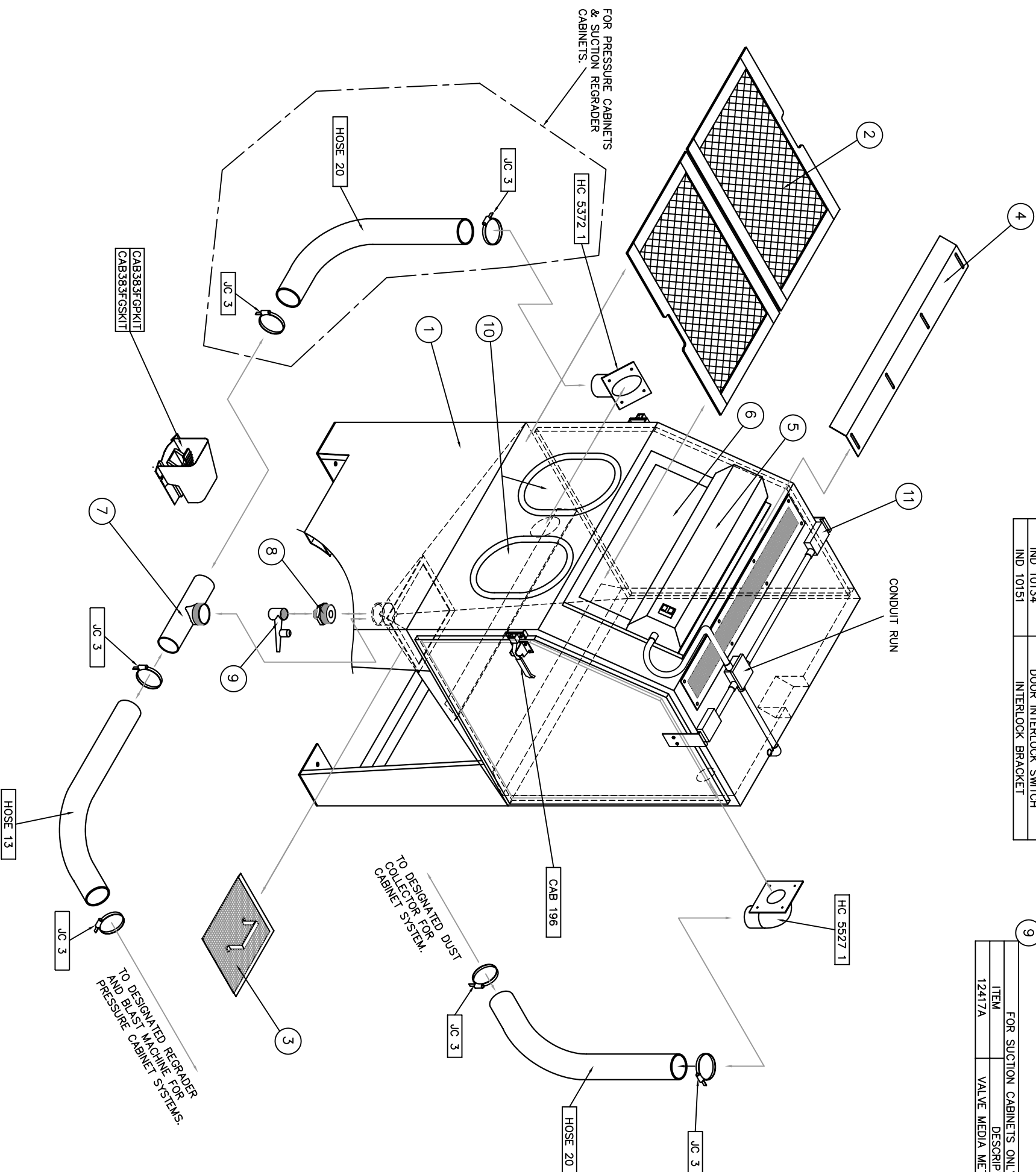

ITEM	DESCRIPTION
IND 10134	DOOR INTERLOCK SWITCH
IND 10151	INTERLOCK BRACKET

ITEM	DESCRIPTION
IND 800COMP & IND 1000COMP	SUCTION WHEN REQUESTED BY CUSTOMER

ITEM	DESCRIPTION
IND 10134	DOOR INTERLOCK SWITCH
IND 10151	INTERLOCK BRACKET

ITEM	DESCRIPTION
12417A	VALVE MEDIA METERING ASS'Y

ITEM	DESCRIPTION
12417A	VALVE MEDIA METERING ASS'Y

ITEM	DESCRIPTION
12417A	VALVE MEDIA METERING ASS'Y

ITEM	DESCRIPTION
12417A	VALVE MEDIA METERING ASS'Y

ITEM	DESCRIPTION
12417A	VALVE MEDIA METERING ASS'Y

FOR MINOR PARTS & FITTINGS,  
SEE RELEVANT G.A. DRAWING,  
FOR INDIVIDUAL CABINET SYSTEM.

ISSUE No	MOD. No	DATE
1	ORIGINAL	27.10.99
2	3827	31.07.2002

THIS DOCUMENT IS THE PRIVATE & CONFIDENTIAL PROPERTY OF HODGE CLEMO LIMITED & MUST NOT BE REPRODUCED OR DISCLOSED TO ANY THIRD PARTY WITHOUT PRIOR WRITTEN CONSENT OF THE AFOREMENTIONED COMPANY.

**Enviroclean**

HODGE CLEMO LIMITED,  
ORGRFAVE DRIVE,  
SHEFFIELD,  
S13 9NR,  
TEL. 0114 2540600  
FAX. 0114 2540250

MAJOR PARTS BREAKDOWN  
DRAWING FOR COMP CABINETS  
ISOMETRIC  
PROJECTION  
DRAWING No HC-6693