



**Hodge Clemco Ltd**

**Portable Abrasive  
Blast Cleaning Machines  
2452/2040/1440/1028**

**Parts Identification**

**Owner's Manual**

Date of Issue: 01.01.03    TS.OM 267

Hodge Clemco Ltd  
Orgreave Drive  
Sheffield  
S13 9NR  
Tel: 0114 254 8811  
Email [sales@hodgeclemco.co.uk](mailto:sales@hodgeclemco.co.uk)  
[www.hodgeclemco.co.uk](http://www.hodgeclemco.co.uk)

## **Machinery Directive**

(89/392/EEC amended by 91/368/EEC, 93/44/EEC and 93/68/EEC)

### **EC Declaration of Conformity**

We HODGE CLEMCO LTD declare that the supplied equipment when installed and used in accordance with the owners manual provided, conforms with the essential health and safety requirements of the above Directive(s)

Industrial Products Manager



Managing director



### **MAINTENANCE INSPECTION CONTRACT**

In response to numerous requests we are now able to offer a Maintenance Inspection Contract for your Clemco Equipment.

These request have been made by customers who appreciate the benefits of regular inspection/servicing on a planned basis. The remedial work which follows a breakdown or worse, the need for early equipment replacement due to accelerated wear may easily exceed the cost of a Maintenance Inspection Contract. If you would like further details please contact our Customer Services Department on 0114 2548811

A request for more information does not represent any form of commitment on your behalf, so can you afford to say 'NO' at this stage?

We look forward to hearing from you soon.

### Contractor Blast Machine - Parts Identification

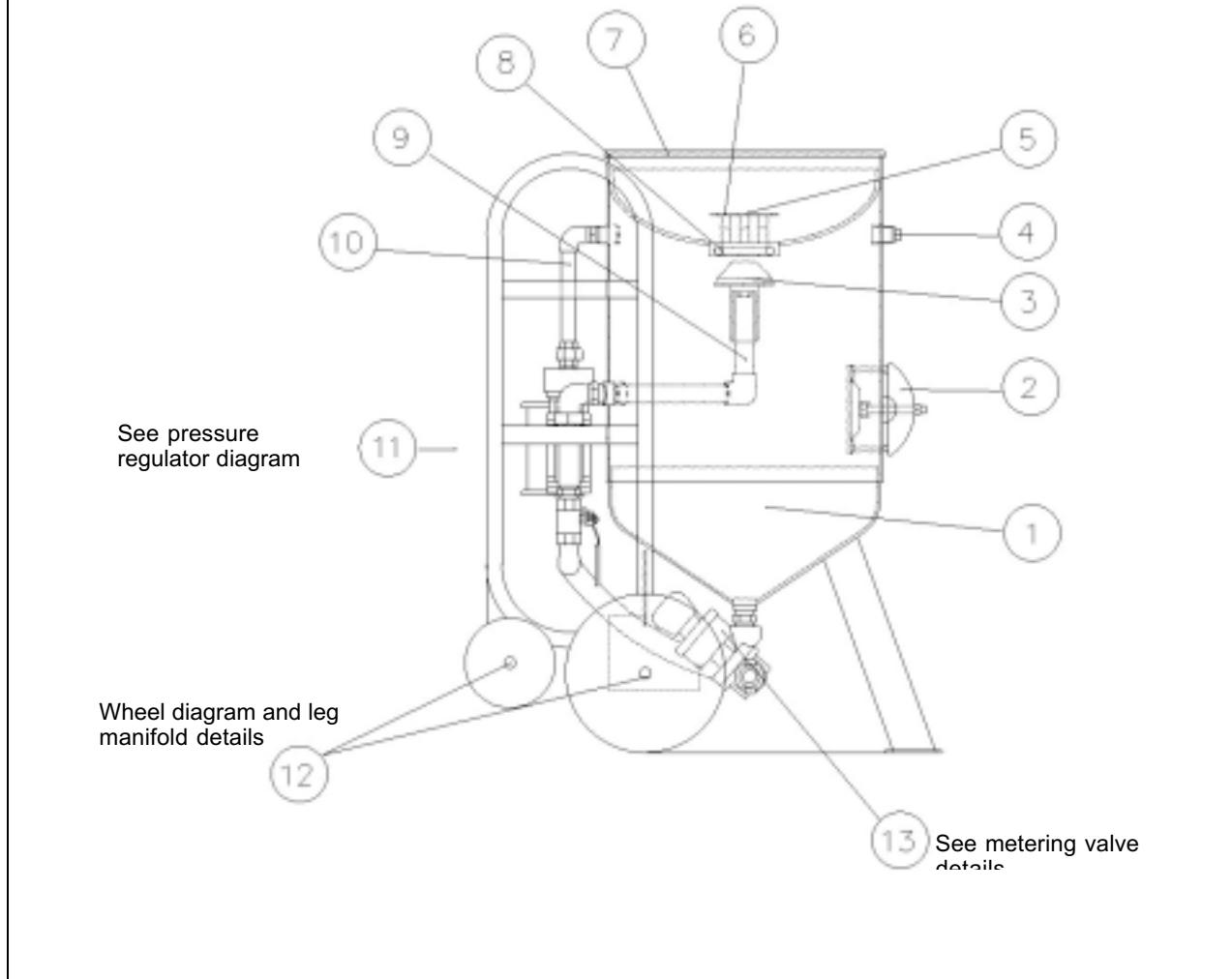

No	Part Description	2452	2040	1440	1028
1	Contractor shell	2452 NC SH	2040 NC SH	1440 NC SH	1028 NC SH
2	Inspection door assembly	PNC 10	PNC 10	PNC 10	MP 6 18
3	Pop up valve assembly	PNC 22	PNC 22	PNC 22	CMP 2
4	Plug	P 71G	P71G	P71G	MP 32G
5	Screw	FAS M8 73A	FAS M8 73A	FAS M8 73A	FAS M10 11A
6	Umbrella	PNC 23	PNC 23	PNC 23	
7	Safety Edging Trim	P 25	P25	P25	P25
8	Sealing Ring	P 5	P 5	P 5	MP 5
9	Pop up valve stem	PNC 38	PNC 36	PNC 32	
10	Piping details - see page 4				
11	Pressure Regulator and leg manifold details - see page 5				
12	Wheels and leg manifold details - see page 6				
13	Abrasive metering valve – see pages 7 - 8				

### Piping Details

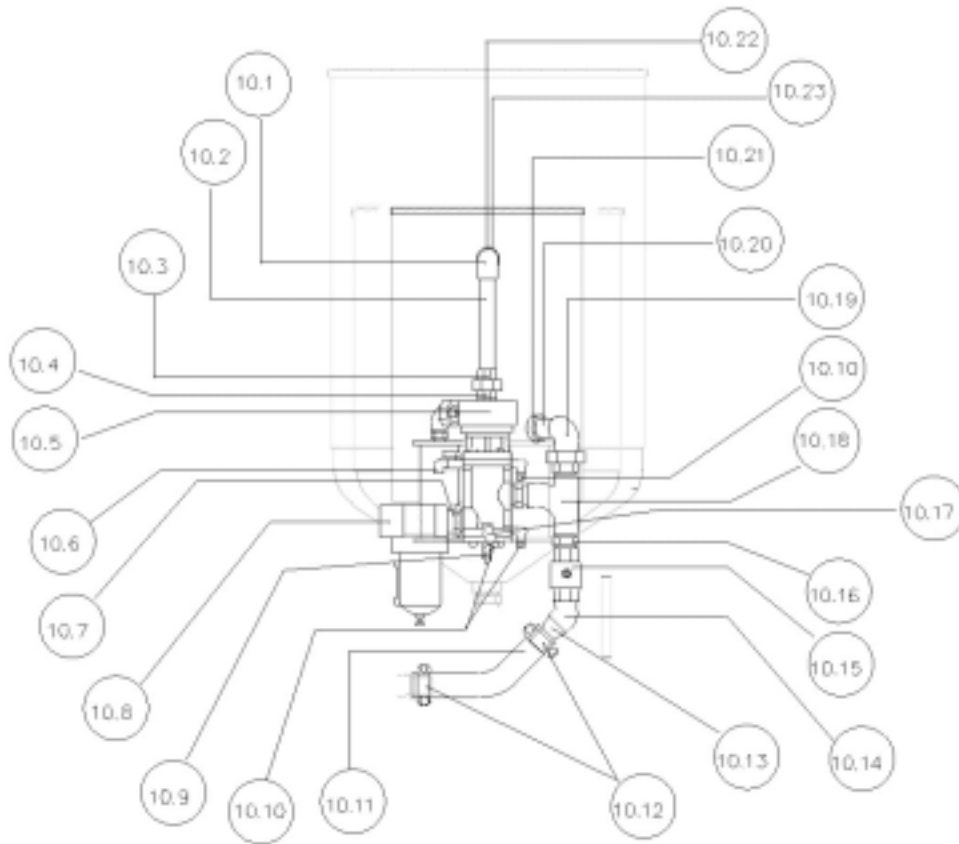

Piping Details		2452	2040	1440	1028
10.1	Elbow	P 86	P86	P86	MP 20 G
10.2	Pipe	PNC 28	PNC 17	PNC 45	
10.3	Union	P 56	P 56	P 56	MP 17 G
10.4	Nipple	P 98	P 98	P 98	PI 65 G
10.5	Recova valve & silencer	RMS 100D	RMS 100D	RMS 100D	RMS 100D
10.6	Petcock	RM9	RM9	RM9	RM 9
10.7	Nipple	P 63	P 63	P 63	P 93 G
10.8	Water Separator	P 23X	P 23X	P 23X	MP 14 8 X
10.9	Tap	MF 2	MF 2	MF 2	MF 2
10.10	Adaptor	RM 23	RM 23	RM 23	RM 23
10.11	Blast Hose	XX HOSE 4C	XX HOSE 4C	XX HOSE 4C	XX HOSE 1
10.12	Clamp	HD 004	HD 004	HD 004	BW 8
10.13	Adaptor	STC 15	STC 15	STC 15	CAB A3 S
10.14	Elbow	PNC 15	PNC 15	PNC 15	MP 20 G
10.15	Valve	P 21	P 21	P 21	MP 1
10.16	Nipple	PN 2G	PN 2G	PN 2G	MP 15 G
10.17	Elbow	RCAMV 8	RCAMV 8	RCAMV 8	RCAMV 8
10.18	Tee Pitcher	PNC 14	PNC 14	PNC 14	MP 23 G
10.19	Elbow Union	PNC 13	PNC 13	PNC 13	
10.20	Pipe		PNC 32	PNC 32	XX PIPE 1G
10.21	Nipple	PN 2			
10.22	Nipple	P 3	P 3	P 3	MP 15G
10.23	Union				MP 17G

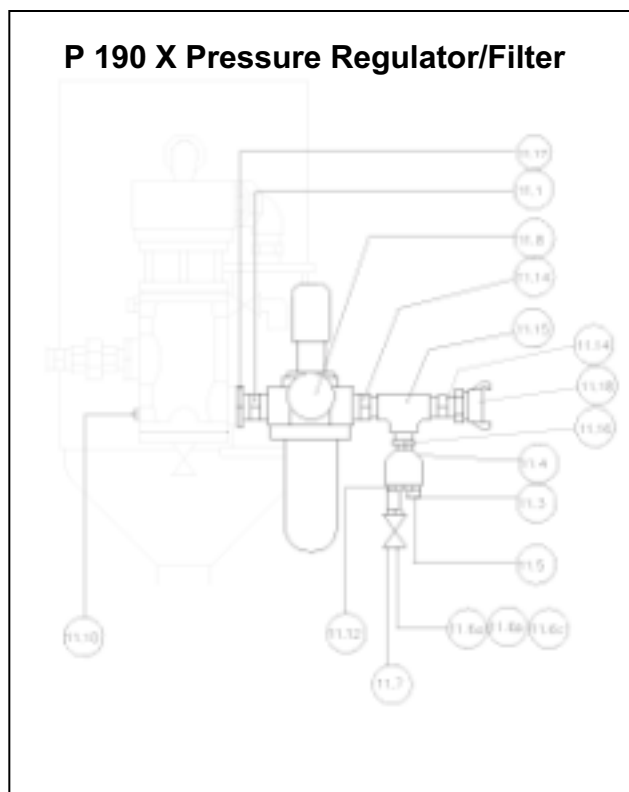
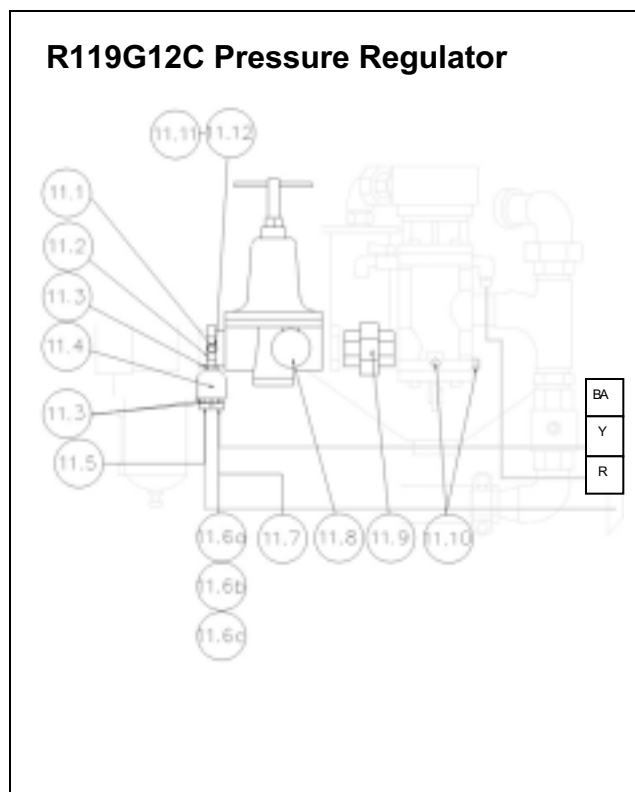

		<b>2452</b>	<b>2040</b>	<b>1440</b>	<b>1028</b>
<b>11</b>	<b>Pressure Regulator</b>	R119G12C	R119G12C	R119G12C	P 190 X
<b>11.1</b>	Nipple	P 62A	P 62 A	P 62A	RM 11A
<b>11.2</b>	Elbow	RCAMV 7	RCAMV 7	RCAMV 7	
<b>11.3</b>	Adaptor	RM 23	RM 23	RM 23	RM 23
<b>11.4</b>	Twin Block	RCAMV 7	RCAMV 7	RCAMV 7	RCAMV 7
<b>11.5</b>	Air Hose (Red) (Yellow)	XX HOSE 7 (R) (Y)	XX HOSE 7 (R)(Y)	XX HOSE 7 (R) (Y)	XX HOSE 7 (R)(Y)
<b>11.6a</b>	Tailpiece	A 16	A 16	A 16	A 16
<b>11.6b</b>	'O' Clip	A 17	A 17	A 17	A 17
<b>11.6c</b>	Union Nut	A 18	A 18	A 18	A 18
<b>11.7</b>	Breathing Air Hose	XX HOSE 7S	XX HOSE 7S	XX HOSE 7S	XX HOSE 7S
<b>11.8</b>	Air Pressure Gauge	CAP S9	CAP S9	CAP S9	KB 11
<b>11.9</b>	Union	P 124	P124	P124	
<b>11.10</b>	Plug	MP 40A	MP 40A	MP 40A	MP 40A
<b>11.11</b>	Seal	KB 916	KB 916	KB 916	
<b>11.12</b>	Bulkhead Adaptor	RCAMV 4	RCAMV 4	RCAMV 4	RCAMV 4
<b>11.13</b>	Tap				MF 2
<b>11.14</b>	Nipple				P165 G
<b>11.15</b>	Tee				MP 23G
<b>11.16</b>	Bush				P 211G
<b>11.17</b>	Bulkhead Adaptor				P 99G
<b>11.18</b>	Coupling				BW2
For older style machines:					
Pressure Regulator		P 20	P 20	P 20	MP 149

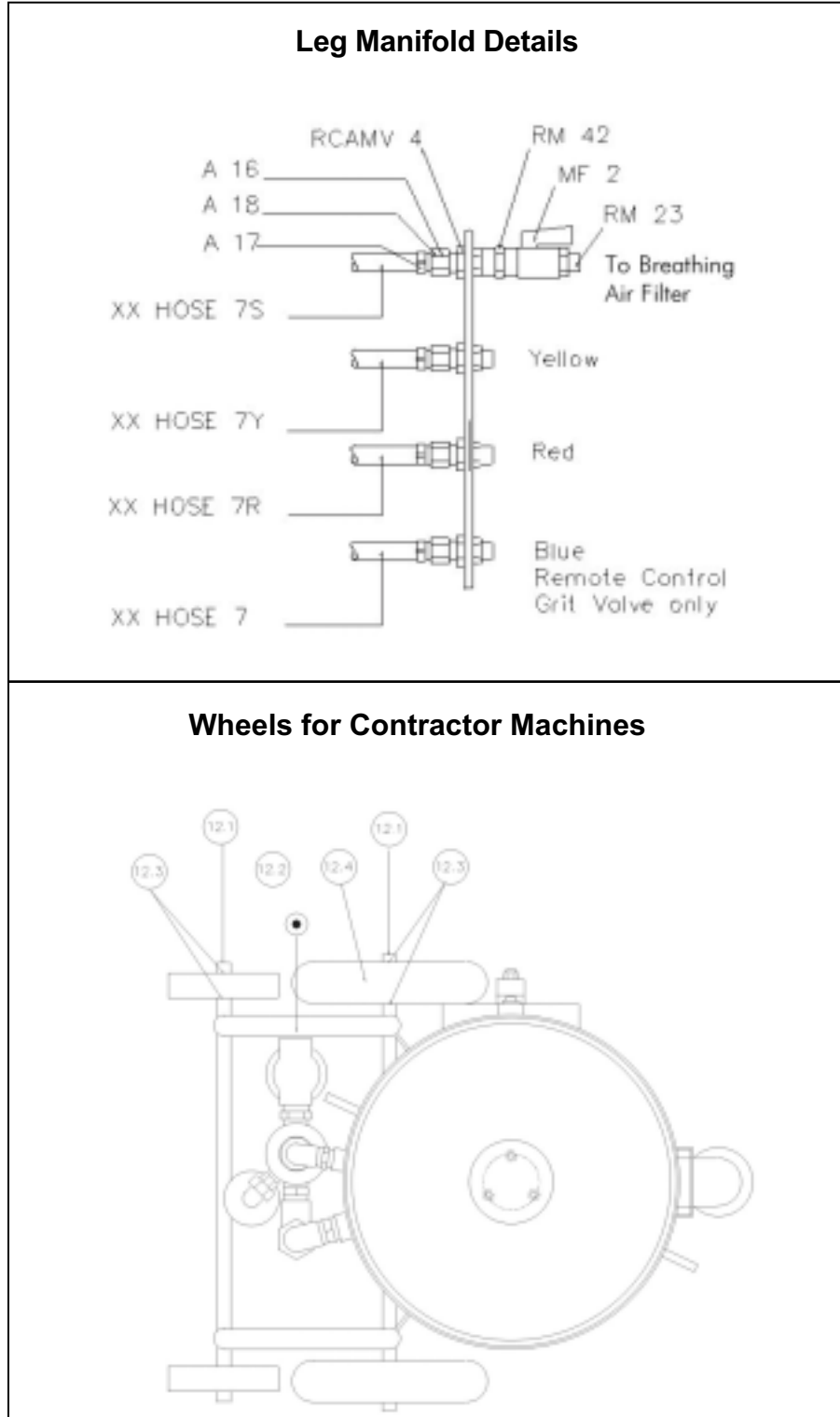

<b>12</b>	<b>Wheels</b>	<b>2452</b>	<b>2040</b>	<b>1440</b>	<b>1028</b>
12.1	Cotter Pin	P 6A	P 6A	P 6A	MP 46
12.2	Wheel	PNC 26			
12.3	Washer	FAS 16BSW80	FAS 16BSW80	FAS 16BSW80	FAS M12 84A
12.4	Wheel	P 18 14	PNC 12	P 18 8	MP 11

### 13 Abrasive Metering Valves

<b>13</b>	<b>Abrasive Metering Valve</b>	<b>2452</b>	<b>2040</b>	<b>1440</b>	<b>1028</b>
<b>13.1</b>	Expendable Abrasive Metering Valve	P7	P7	P7	MP7
<b>13.2</b>	Minor Grit Valve				MPC 240
<b>13.3</b>	Steel Grit Valve	P17	P17	P17	MP8SG
<b>13.4</b>	Remote Control Valve	IND 11096	IND 11096	IND 11096	

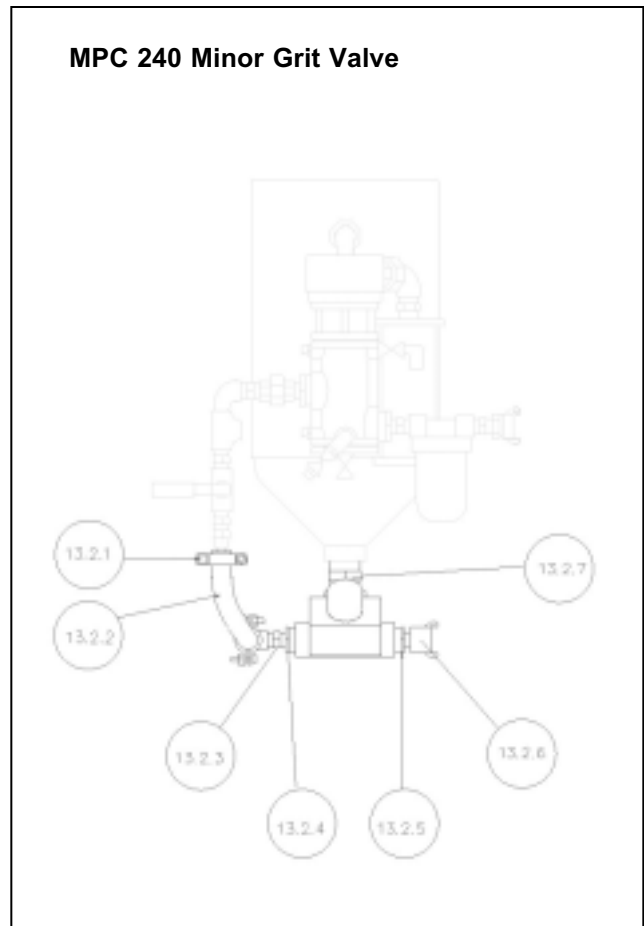
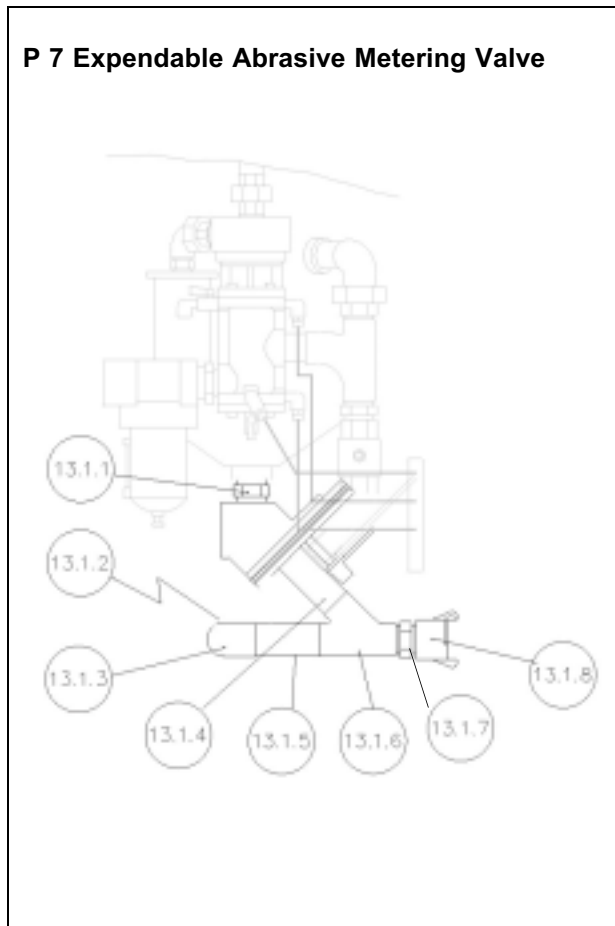

<b>P7</b>	<b>Expendable Abrasive Metering Valve</b>		<b>MPC 2 40</b>	<b>Minor Grit Valve</b>	
<b>13.1.1</b>	Nipple	P 8A 6	<b>13.2.1</b>	Clamp & Bolts	BW 8
<b>13.1.2</b>	Adaptor	STC 15	<b>13.2.2</b>	Hose	XX HOSE 1
<b>13.1.3</b>	Elbow	P 68	<b>13.2.3</b>	Nipple	MP 15G
<b>13.1.4</b>	Baffle Grit Pipe	P 29	<b>13.2.4</b>	Bush	P 96G
<b>13.1.5</b>	Pipe	P 65	<b>13.2.5</b>	Nipple	P 132MS
<b>13.1.6</b>	Y piece	P 8	<b>13.2.6</b>	Coupling	MP9
<b>13.1.7</b>	Nipple	P 8A	<b>13.2.7</b>	Nipple	P 8A 6
<b>13.1.8</b>	Coupling	P 9			

### 13.3 P17 Steel Grit Valve

13/3/1	Nipple	P 8A 6S
13.3.2	Bolt	FAS 8BSW 3
13.3.3	Upper Flange	SGV 2
13.3.4	Washer	FAS 8BSW 80
13.3.5	Nut	FAS 8BSW 90
13.3.6	Set Screw	FAS 8BSW 11
13.3.7	Adaptor	STC 15
13.3.8	Elbow	P 28
13.3.8	Lower Flange & Tee	RCAMV 2
13.3.10	Nipple	P 8A
13.3.11	Coupling	P 9

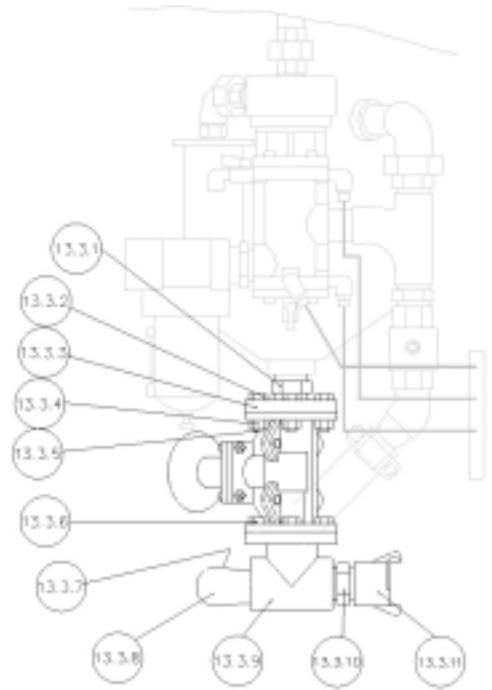

### MP 8SG Steel Grit Valve for 1028

1	Nipple	P 249
2	Upper Flange	MSGV 2
3	Lower Flange	MSGV 1
4	Split Pin	MP 48
5	Coupling	P9
6	Rubber Sleeve	MSGV3

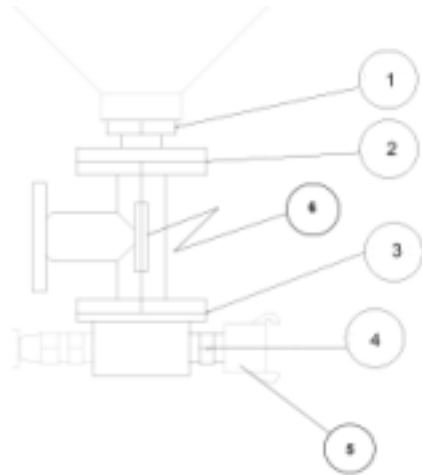

### 13.4 IND 11096 Remote Control Valve

13.4.1	Nipple	P 8A 6S
13.4.2	Adaptor	STC 15
13.4.3	Elbow	RM 68
13.4.4	Nipple	RM 69
13.4.5	Elbow	RM 67
13.4.6	Adaptor	RCAMV 9
13.4.7	Coupling	P 9

